

# PINT SIZE TABLE RUNNER

— April —

**KITS** available at  
ShabbyFabrics.com  
*while supplies last!*

## PLEASE NOTE

All seams are ¼"

WOF = Width of Fabric

RST = Right Sides Together

## REQUIRED MATERIALS

- 8" × 15" dusty pink with flowers for **HST (Fabric A)**
- 7" × WOF cream floral for **HST** and **strip piecing (Fabric B)**
- 4" × 21" teal ditsy for **strip piecing (Fabric C)**
- 3½" × 14" dark red with flowers for **block centers** and **cornerstone (Fabric D)**
- 4" × 14" orange pink stripe for **sashing (Fabric E)**
- 14" × 14" cream with orange streaks for **appliqué backgrounds (Fabric F)**
- 7" × WOF teal mottled for **binding (Fabric G)**
- 27" × 21" for **backing**
- various scraps for appliqué
- fusible webbing

## CUT FABRICS

From dusty pink with flowers (**Fabric A**), cut:

- (8) 3" × 3" squares for **HST**  
**OR, if using Star Singles 2" Half Square Triangle Papers**, (2) 6½" × 6½" squares

From cream floral (**Fabric B**), cut:

- (8) 3" × 3" squares for **HST**  
**OR, if using Star Singles 2" Half Square Triangle Papers**, (2) 6½" × 6½" squares
- (2) 1½" × 21" for **strip piecing**

From teal ditsy (**Fabric C**), cut:

- (2) 1½" × 21" for **strip piecing**

From dark red with flowers (**Fabric D**), cut:

- (4) 2½" × 2½" squares for **block centers**
- (1) 1" × 1" square for **cornerstone**

From orange pink stripe (**Fabric E**), cut:

- (4) 1" × 6½" for **sashing**

From cream with orange streaks (**Fabric F**)

**Noting orientation of streaks**, cut:

- (2) 5½" × 13" rectangles for **appliqué backgrounds**

From teal mottled (**Fabric G**), cut:

- (2) 2½" × WOF strips for **binding**



Finishes to: 13" × 23"

## RECOMMENDED PRODUCTS

- Star Singles 2" Half Square Triangle Paper
- Creative Grids Folded Corner Clipper Tool #CGRFCC
- Creative Grids 6½" × 12½" Ruler #CGR612
- Wafer 1 Lightbox
- Appli-Fuse Silicone Mat - 12" × 18"

All available at [ShabbyFabrics.com](http://ShabbyFabrics.com)

As seen on our  
**PINT SIZE TABLE RUNNER  
SERIES - APRIL**  
video featured on our YouTube channel:



[YouTube.com/Shabby Fabrics](https://www.youtube.com/ShabbyFabrics)

## HALF SQUARE TRIANGLES

*If using Star Singles 2" Half Square Triangle Paper:*  
 Use (2) papers, (2) 6½" × 6½" Fabric A squares, and (2) 6½" × 6½" Fabric B squares (fabric squares will be slightly larger than the papers). Follow instructions included with papers to make a total of (16) A/B HST and skip ahead to ★ Strip Piecing.

**STEP 1:** On the back of (1) 3" × 3" B square, draw a line diagonally from corner to corner.

**STEP 2:** Layer this square and (1) 3" × 3" A square, RST, making sure to line up the edges.

**STEP 3:** Sew ¼" on both sides of the drawn line.

**STEP 4:** Cut on the drawn line. Press toward Fabric A.

**STEP 5:** You will now have two A/B units.

**STEP 6:** Repeat Steps 1-5 to make a total of (16) A/B units.

**IMPORTANT:** Trim each HST to 2½" × 2½".

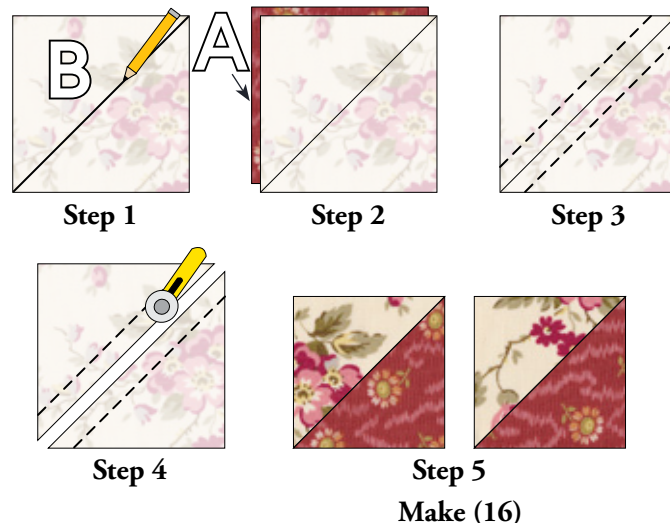

## ★ STRIP PIECING

Sew (1) Fabric B strip to (1) Fabric C strip. Press open.

Cut strip sets into 2½" segments.

Repeat to make a total of (16) units. Each unit should measure 2½" × 2½".



## FLOWER BLOCKS

Arrange units as shown. Sew together into rows. Press toward strip pieced units.

Sew rows together. Press away from block center.

Block should measure 6½" × 6½".

Make a total of (4) Flower Blocks.

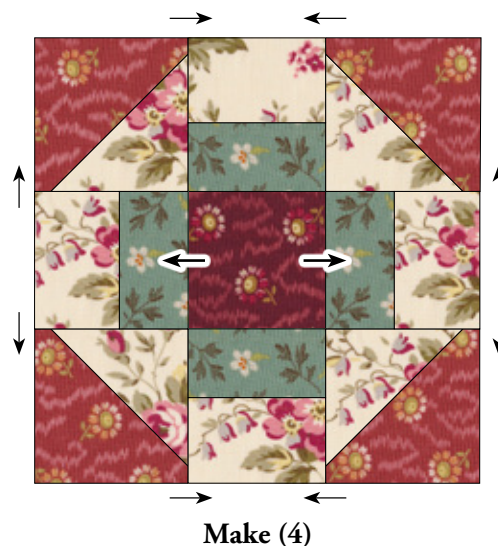

## APPLIQUÉ

NOTE: With the exception of the umbrella handle and bow, the appliqué design is symmetrical, so there is no need for a reverse diagram when tracing shapes for fusible appliqué. (*Reversed umbrella handle and bow shapes are provided for tracing.*)

Gently peel fusible paper from the back of each shape. Refer to Assembly Diagram to arrange shapes on background fabric.

Appliqué in place using the method and stitch of your choice.



Appliqué - Make (2)

## ASSEMBLE TABLE RUNNER

Arrange blocks as shown. Sew **sashing** strip between two blocks; press toward sashing. Sew sashing strips to each side of **cornerstone**; press toward sashing. Sew pieced blocks and sashing unit together; press toward sashing unit. Sew one appliqué unit to each end as shown; press toward pieced blocks.

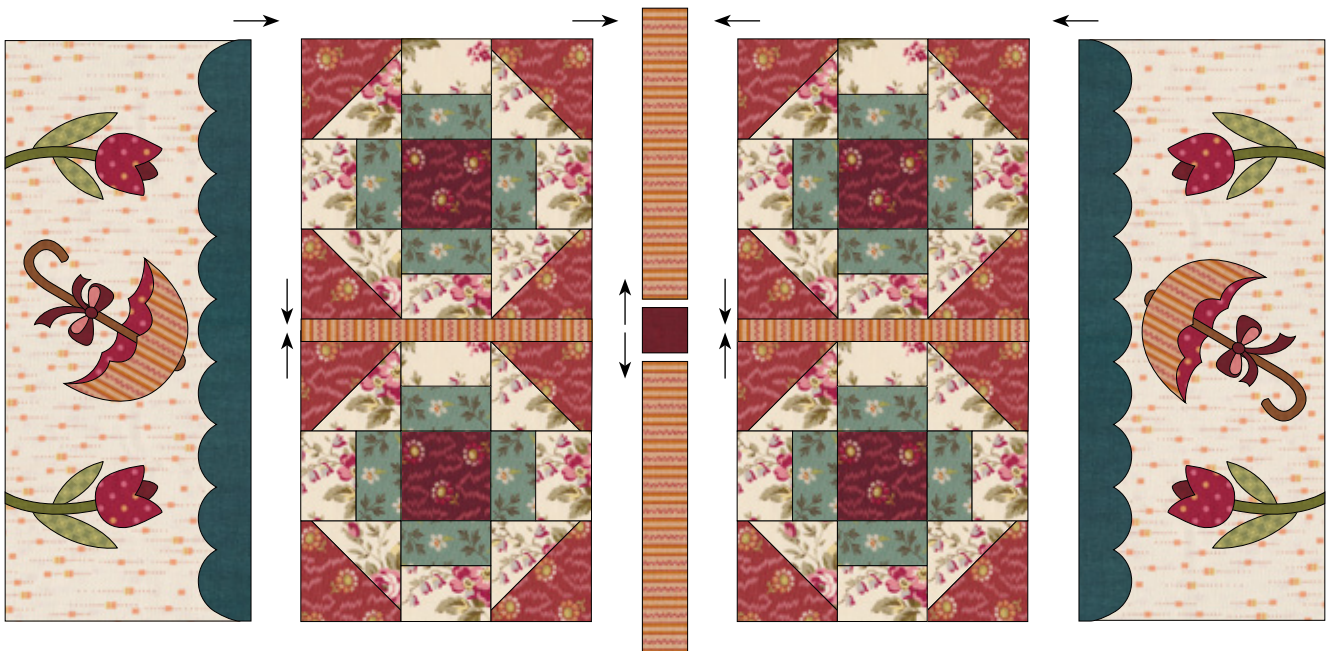

## FINISH TABLE RUNNER

Layer top, batting, and backing. Quilt as desired.

Piece **binding** into one long strip. Fold in half lengthwise, wrong sides together, and press. Line up raw edges of the binding with the raw edge of the table runner. Sew binding to the front side of the table runner, starting at any side. Turn the binding over and hand stitch to the back of the table runner.

Shop 24/7 for BOMs and Clubs, kits, and *more* at [ShabbyFabrics.com!](http://ShabbyFabrics.com)

# PINT SIZE TABLE RUNNER

— *April* —

© 2022 Shabby Fabrics

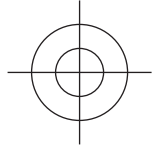

## Assembly Diagram

With the exception of the umbrella handle (2) and bow (4 through 8),  
design is symmetrical;  
diagram can be used for tracing and for placement

Align bullseye marks ⊕ on page 1 with  
bullseye marks ⊕ on page 2, then tape  
pages together

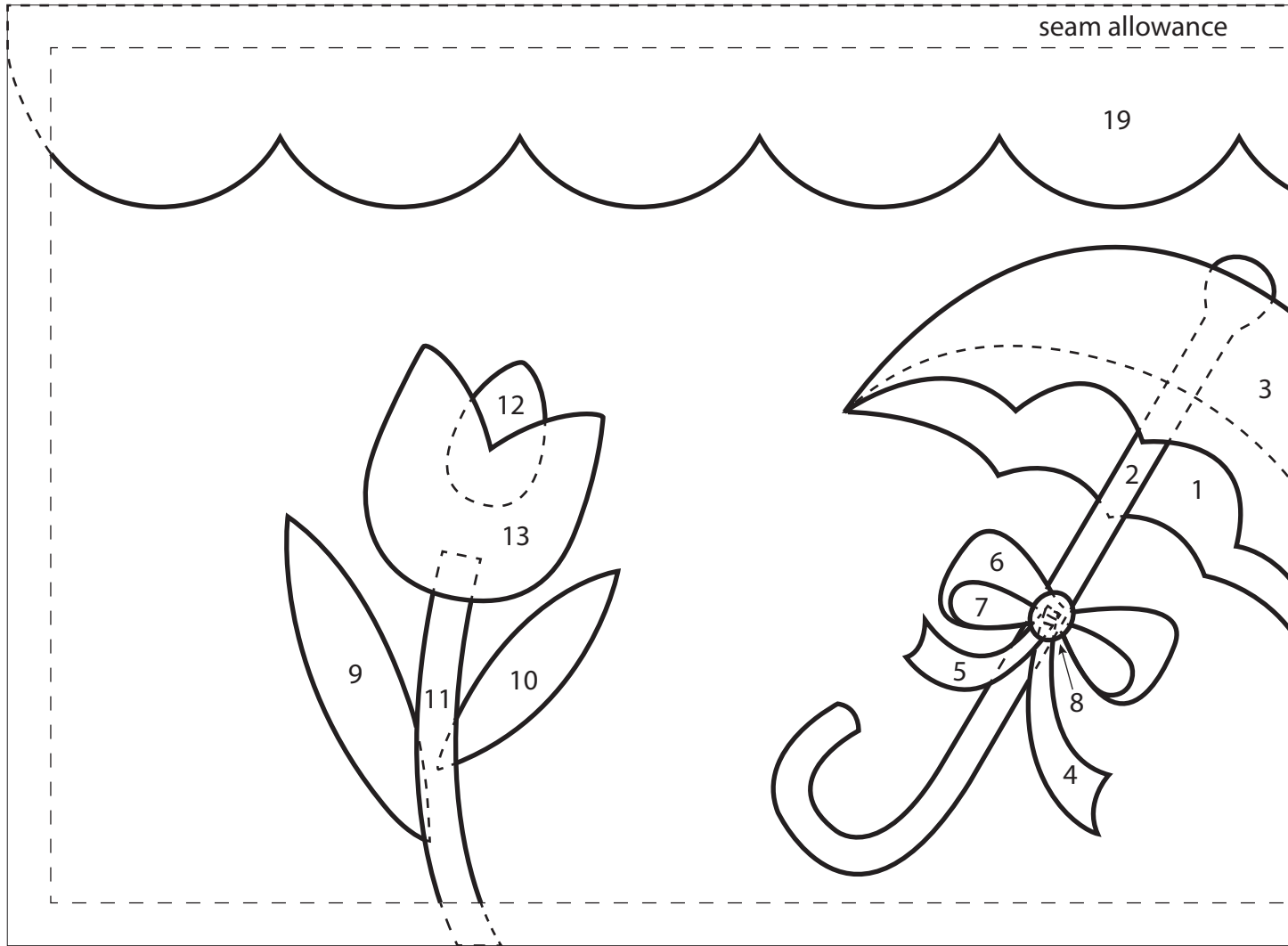

ShabbyFabrics.com

For personal use ONLY, not for commercial production. No part of this pattern may be reproduced, shared, or distributed in any form unless given express written consent by Shabby Fabrics. Not to be used with any online classes or video tutorials other than the official Shabby Fabrics tutorial. All designs, photographs, and images are protected by federal copyright law. All rights reserved.

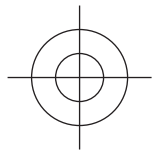

# PINT SIZE TABLE RUNNER

— April —

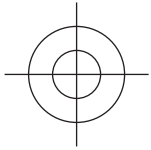

© 2022 Shabby Fabrics

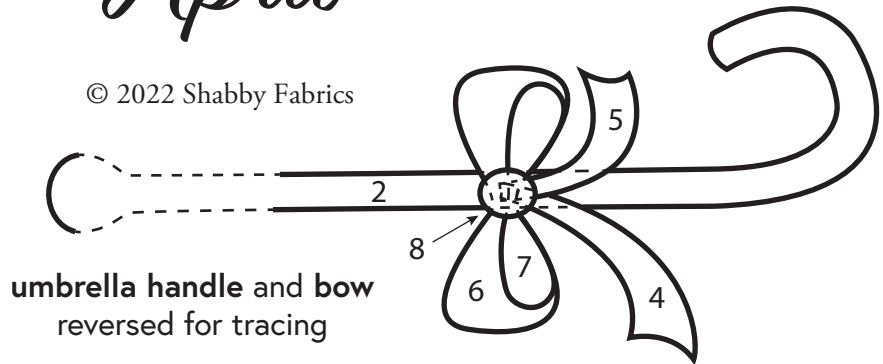

seam allowance

19

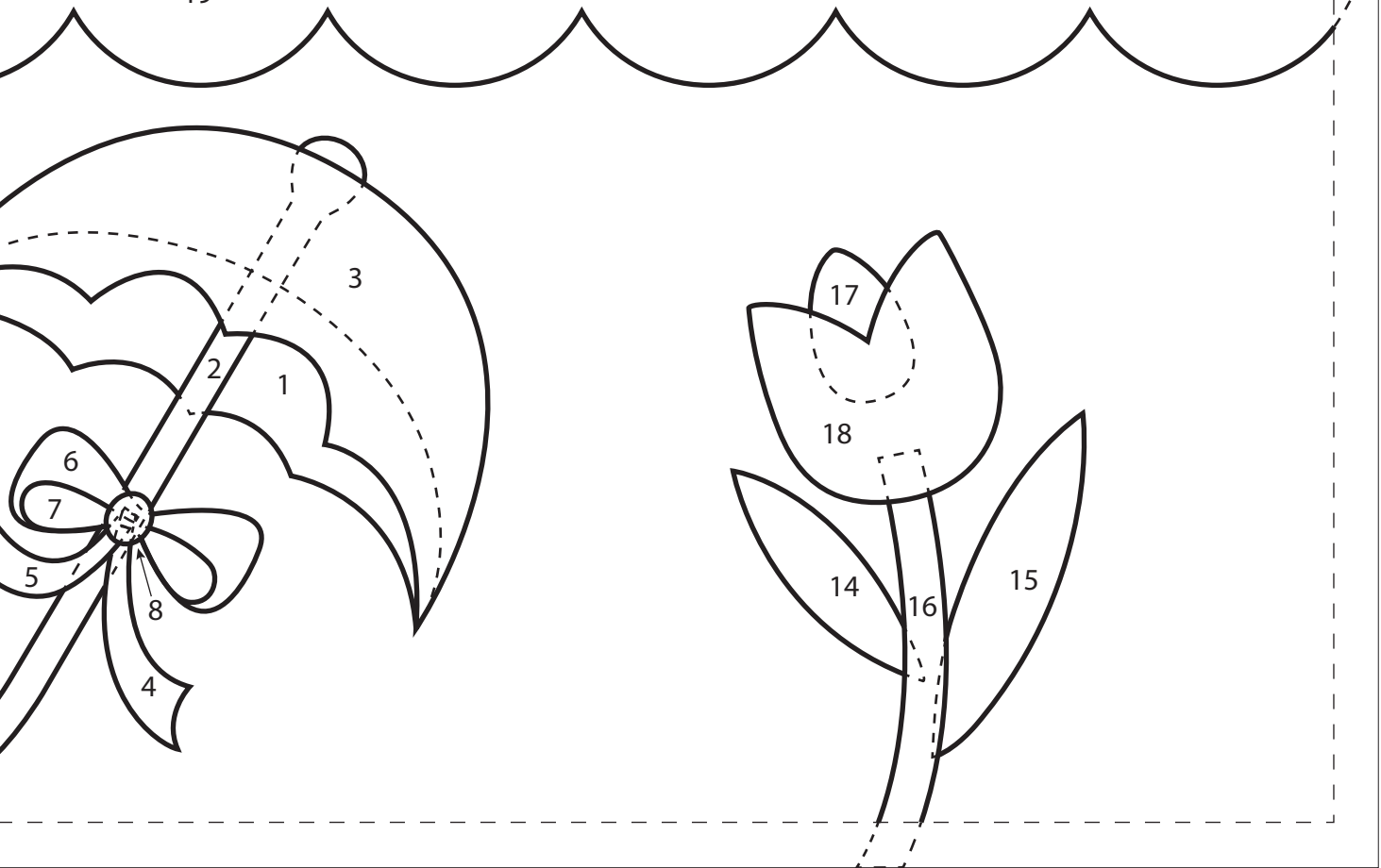

ShabbyFabrics.com

For personal use ONLY, not for commercial production. No part of this pattern may be reproduced, shared, or distributed in any form unless given express written consent by Shabby Fabrics. Not to be used with any online classes or video tutorials other than the official Shabby Fabrics tutorial. All designs, photographs, and images are protected by federal copyright law. All rights reserved.

