

My Favorite Snap Bag

I like this bag better because there is no seam in the inside.

Once again, the bag can be made in any size. This bag finishes about 8" x 8 1/2"

To make the bag bigger just add to the main pieces

Cut

1-11" x 9" piece for the outside

2-7 3/4 x 9" inch pieces for lining

2- 7 3/4 x 9" batting

2-2 1/4 x 9" casing strip

2- 4" squares for prairie points

3x5 scrap for handle(optional)

Pressing after each step makes the bag easier to put together.

All seams are 1/4 inch

1. Make prairie points if using. Find center of outside piece , 9 inch side, place prairie point in center and attach 9" 2 1/4 inch piece with a 1/4 inch seam. Do the same to the other side.

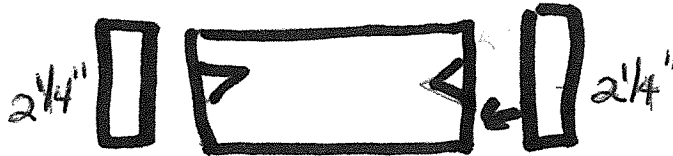

2. If you are using iron on stabilizer or batting place on the 9" x 7 3/4 " piece. Sew 7 3/4 inch pieces along the 9 inch sides together, leaving a 2 -3 inch unsewn spot in the bottom seam for turning.

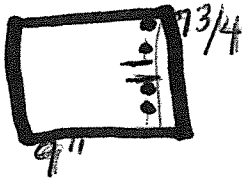

3. Now you have the inside and outside of your bag. If you are adding a tab (see below) sew it, long side placing it where you want . I like to place them below the casing.



4. Sew short sides of front and back together, right sides facing. Sew other side. Both ends are now stitched.

5. Fold bag so that outside is on one side and lining is on other. Stitch down both sides leaving a small opening on one side of the side to slip in tape measure. Match casing seams. Casing seems to match up best if seems are nested.

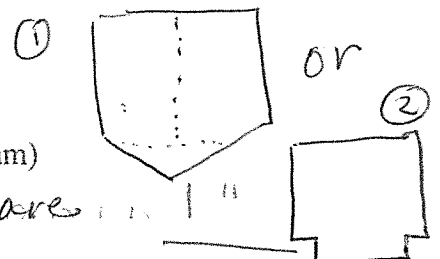
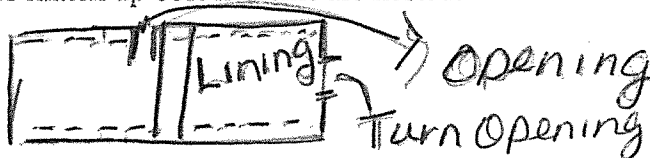

6. If your would like your bag to have a bottom, sew corners (see diagram)

Cut out 1" square
Fold and stitch

7. Turn using the opening in the bottom of the lining. Stitch opening shut.
8. Stuff lining in bag and press.
9. Top stitch casing along prairie point or bottom edge. Topstitching on top edge is optional

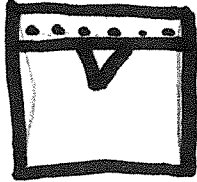

10. Cut tape $\frac{1}{2}$ inch smaller than bag casing. Round edges and cover with some kind of tape to cover sharp edges. Insert curved side in and hand stitch opening closed. Enjoy!



Prairie Point- Fold Square in half. Fold ends in to make a point.

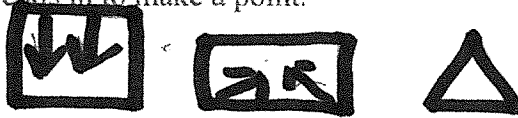

Tab- use a scrap 3x5 works good. Fold long sides in $\frac{1}{4}$ of an inch. Fold in half and top stitch both sides.



Turn in edges $\frac{1}{4}$ "



Easy Snap Bag

Cut

10" x 6 1/2" (outside)

1-14 x 6 1/2" Lining and casing

10" x 6 1/2" batting

Press 14 x 6 1/2 inch under 1/4 inch at 6 1/2 in end.

Make a sandwich with the largest piece on the bottom, wrong side facing. Center batting and outside piece, right side up on lining. Pieces will be wrong sides together. Turn excess down to make a casing. Make sure both sides are even. Tape is usually 5/8" so casing has to be at least that wide. Top stitch down. If you are going to add a prairie point handle, make prairie point and place in the middle and add with topstitching.

Cut tape measure 1/2 inch less than width of bag. Round ends of measuring tape and use some kind of tape (Masking, Painter etc.) to cover sharp ends. Remember not to use your good scissors! Slide tape in each side of casing. I use curved side in. Using a 1/4 inch seam, so down both sides, right sides together. Trim and turn. The measurements can be adjusted for any size bag.

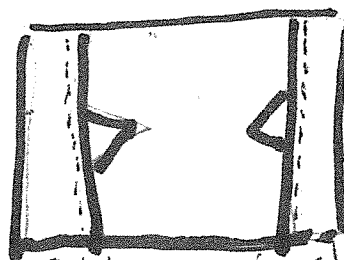
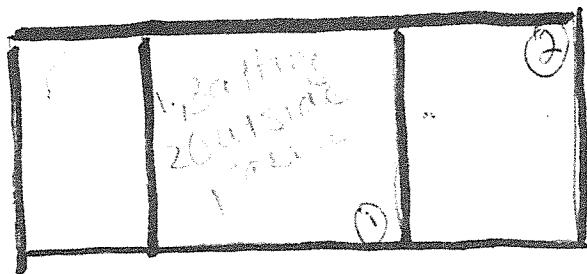

Fold and stitch

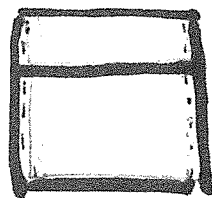

Stitch wrong sides together