

Iron Caddy / Pad

Materials:

- 21" x 28" Main fabric for caddy body
- (2) 4" x 14" Main fabric pieces for handles
- 21" x 28" Heat resistant ironing board fabric
- (2) 21" x 28" layers of Insul-Bright
- (2) 1" or larger buttons (shank buttons work well!)
- 9' of $\frac{1}{4}$ " wide elastic – cut into two $4\frac{1}{2}$ " lengths
- $\frac{1}{4}$ " yard contrast fabric for binding – cut $2\frac{1}{4}$ " strips; join together to make approximately 90" of binding

Tools needed – coordinating cotton thread, scissors, pins, rotary cutter, ruler and cutting mat, fine mechanical lead pencil; and sewing machine with regular foot and walking foot

Marking the heat resistant fabric - Mark dots as shown below in diagram (A) by measuring $8\frac{1}{4}$ " from the left and $7\frac{3}{4}$ " down from the top and then $7\frac{3}{4}$ " up from the bottom. Do the same from the right side, $8\frac{1}{4}$ " in from the right and $7\frac{3}{4}$ " down from the top and $7\frac{3}{4}$ " up from the bottom. Connect the dots to make a rectangle as shown in diagram (B).

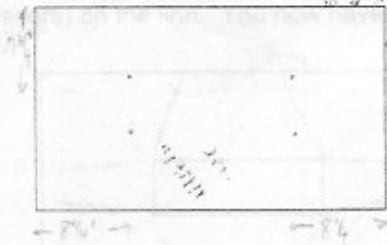

Diagram A

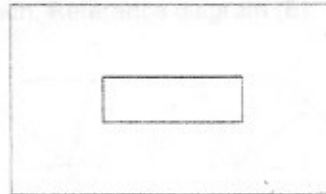

Diagram B

Go out 7" from each side and 7" from top and bottom of the center rectangle you just made and draw two horizontal and two vertical lines to form another rectangle. You will now have a rectangle within a rectangle. Your drawn outside rectangle should measure $19\frac{1}{2}$ " x $25\frac{3}{4}$ ".

Around the outside rectangle, mark for the stitching/fold lines by making dots at the arrow positions. These dots will be 2" away from the dashed lines. Mark stitching lines by connecting the dots to the center rectangle corner as indicated. Draw a diagonal line in each of the four corners as shown. Reference diagram (C).

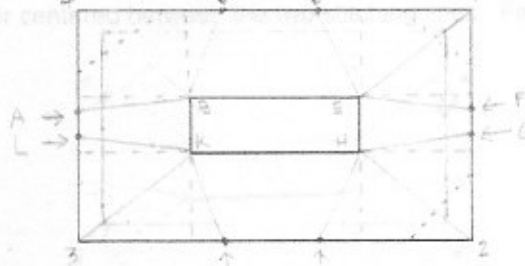

Diagram C

Iron Caddy / Pad

Making the caddy sandwich – put the main fabric face down on your work surface. Next, the two Insul-Bright layers. Last, the heat resistant fabric with the right side facing up. Pin the four layers together at each of the $11 \frac{3}{4} \times 5 \frac{1}{2}$ rectangle corners, the four sandwich corners, and at each of the arrow/dot markings.

Note – when stitching, the bobbin thread will be on the outside main fabric. Check your tension with scraps for this thickness.

Using a walking foot, sew around the center rectangle along the solid pencil line removing the pins as you go. Sew along the lines from A to B to C, continue along the outside perimeter to D. On the outside perimeter stitching, stitch just inside the rectangle so your stitching won't get trimmed off later. Continue stitching D to E to F to G and continue with this pattern on the other side of the caddy sandwich until you are all the way around to L. Reference diagram (D). Sew the diagonal in the corner block as indicated by line E to 1, H to 2, and repeat for the other two corners. Finish by completing the sewing of the outside perimeter lines. Trim (scissors work best!) all layers along the $19 \frac{1}{2} \times 25 \frac{3}{4}$ outer square marking.

Corners – Measure down 4" from the corner 1 toward point E and mark. Use your ruler and draw a line at right angles to the 1/E line as indicated on diagram (C) by a dotted line. Next corner, measure down 4" from the corner 2 toward point H and mark. Draw a line across this corner at right angles to the 2/H mark. Repeat these steps for the other two corners. Stitch just inside these lines and trim (with scissors) on the line. You now have an eight-sided sandwich. Reference diagram (E).

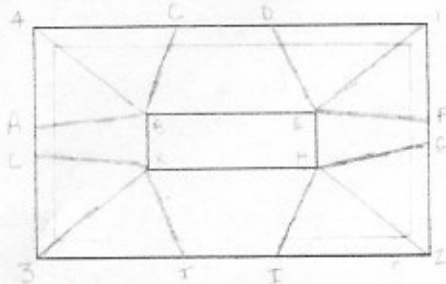

Diagram D

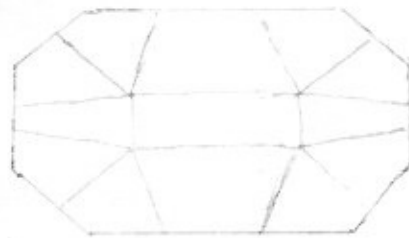

Diagram E

Binding and Loop Closures – attach the binding around the perimeter of the layered sandwich. Apply the binding with the heat resistant fabric face up. Before you roll the binding around the edge, flip the entire unit over. Now apply two elastic loops in the position and direction as shown in diagram (F). Fold one piece of the elastic in half and secure it by stitching back and forth along the binding stitching line. Make sure the fold of the loop is toward the center of the sandwich and the ends point toward the edge and the main fabric is facing up as you are sewing the loops on. The loop should be about $1 \frac{1}{2}$ " from the stitching line or centered between the two stitching lines. Finish your binding.

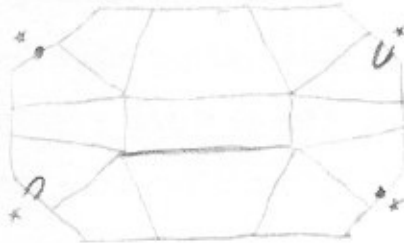

Diagram F

Iron Caddy / Pad

Handles – Cut two pieces of fabric 4" x 14". Press handle pieces in half down the long length. Then un-fold the handles and fold each long edge to the center crease and press the new edges. Now re-fold the piece in half along the original center crease and press again. You should have two handles each 1" x 14" with the raw edges hidden in the middle. Top stitch along each edge about 1/8" in from the edge.

Handles will be attached between the C/D marks and I/J marks. Reference diagram (C). Attach the handles by aligning them 1 1/2" from the indicated stitch/fold lines. Place the raw ends about 1/8" from the edge of the binding and the loop of the handle toward the body of the caddy on the main fabric side. Stitch across the end about 1/8" from the raw edge. Fold the handle along the stitching line off the edge of the caddy. Stitch again directly over the edge of the binding to enclose the raw edge of the handle.

Buttons – Attach buttons on the binding as indicated by the large dots. Reference diagram (F)

Important note – The heat resistant fabric is not meant to be completely impervious to moisture, so take care when choosing a spot to use it!

To Fold – Lift handles up, heat resistant fabric on the inside, fold loop to button in front and repeat, loop to button in back of the iron caddy pad.

1. Place lining and outer fabric right sides together.
2. Sew 5/8" seam along each salvage edge.
3. Turn right side out.
4. Press.
5. Sew a 5/8" casing on each seamed side.
6. Place a mark 6" from the unsewn edges on each end of both casings.



7. Draw a line (on lining fabric) 3-3/4" from edge - parallel to unsewn edges.
8. Cut two 13-1/2" pieces of elastic.
9. Using a bodkin or safety pin, thread elastic through casing.
10. Machine tack, using a zig-zag stitch, at first 6" mark.
11. Continue to thread elastic through casing and machine tack at the second mark.
12. Repeat steps 11 to 13 for the other casing.
13. Edge finish both unsewn edges by zig-zagging or by pressing over 1/4" and stitching down. (Be sure to catch both layers.)
14. Fold edge over to meet the 3-3/4" marked line. Pin. Repeat

Iron Caddy / Pad

Handles – Cut two pieces of fabric 4" x 14". Press handle pieces in half down the long length. Then un-fold the handles and fold each long edge to the center crease and press the new edges. Now re-fold the piece in half along the original center crease and press again. You should have two handles each 1" x 14" with the raw edges hidden in the middle. Top stitch along each edge about 1/8" in from the edge.

Handles will be attached between the C/D marks and I/J marks. Reference diagram (C). Attach the handles by aligning them 1 1/2" from the indicated stitch/fold lines. Place the raw ends about 1/8" from the edge of the binding and the loop of the handle toward the body of the caddy on the main fabric side. Stitch across the end about 1/8" from the raw edge. Fold the handle along the stitching line off the edge of the caddy. Stitch again directly over the edge of the binding to enclose the raw edge of the handle.

Buttons – Attach buttons on the binding as indicated by the large dots. Reference diagram (F).

Important note – The heat resistant fabric is not meant to be completely impervious to moisture, so take care when choosing a spot to use it!

1. Place lining and outer fabric right sides together.
2. **To Fold** – Lift handles up, heat resistant fabric on the inside, fold loop to button in front and repeat, loop to button in back of the iron caddy pad.
3. Sew 5/8" seam along each selvage edge.
4. Turn right side out.
5. Press.
6. Sew a 5/8" casing on each seamed side.
7. Place a mark 6" from the unsewn edges on each end of both casings.



8. Draw a line (on lining fabric) 3-3/4" from edge - parallel to unsewn edges.
9. Cut two 13-1/2" pieces of elastic.
10. Using a bodkin or safety pin, thread elastic through casing.
11. Machine tack, using a zig-zag stitch, at first 6" mark.
12. Continue to thread elastic through casing and machine tack at the second mark.
13. Repeat steps 11 to 13 for the other casing.
14. Edge finish both unsewn edges by zig-zagging or by pressing over 1/4" and stitching down. (Be sure to catch both layers.)
15. Fold edge over to meet the 3-3/4" marked line. Pin. Repeat

Gathering Bag

Materials

- 1 ½ yard for handles and bag
- 1 ¼ yard for lining
- batting scraps 2 inches wide the length of the handle (I like to double mine to make a thicker handle)
- These are really cute made of scraps sewn together to get the measurements needed bags can also be made smaller.

INSTRUCTIONS

1. Cut 9" from outer fabric. Set aside for handles.
2. Place lining and outer fabric right sides together.
3. Trim to make all sides even.
4. Sew 5/8" seam along each selvage edge.
5. Turn right side out.
6. Press
7. Sew a 5/8" casing on each seamed side.
8. Place a mark 6" from the unsewn edges on each end of both casings.

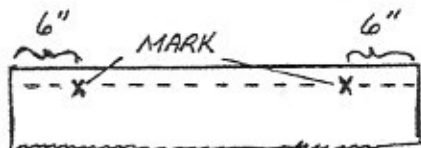

9. Draw a line (on lining fabric) 3-3/4" from edge - parallel to unsewn edges.
10. Cut two 13-1/2" pieces of elastic.
11. Using a bodkin or safety pin, thread elastic through casing.
12. Machine tack, using a zig-zag stitch, at first 6" mark.
13. Continue to thread elastic through casing and machine tack at the second mark.
14. Repeat steps 11 to 13 for the other casing.
15. Edge finish both unsewn edges by zig-zagging or by pressing over 1/4" and stitching down. (Be sure to catch both layers.)
16. Fold edge over to meet the 3-3/4" marked line. Pin. Repeat